



27ft Flybridge Sports Fisherman



The Caribbean 27ft Flybridge Sports Fisherman is a completely new hull

The Caribbean 27 Flybridge Sports Fisherman is the evolutionary mix of two proven blue water off shore performance cruisers, The Caribbean 26 Flybridge Sports Fisherman and the famous Bertram 25 Flybridge cruiser.

The Caribbean 27 sports fisherman is a completely brand new hull which is now both longer and wider it has much more modern lines. She is a high performance styled cruiser, her layout is very versatile and can be easily customised to suit your boating requirements. The 27 now carries more fuel, more water and has a larger cockpit. Put this together with a hull that is 20 years proven from the 26 Caribbean and we are sure that the new 27 will be around for another 20 years.

Specifications

Adult Capacity: 8

Fuel Capacity: 550L underfloor tank

Approx hull Weight: 3100kg

Beam Maximum: 3.21m (10'7")

Overall Length: 8.23m (27') + swim and bow platforms

Cockpit Area: 7.3sqm

Twin Mercruiser V6 4.3L 220hp MPI Sterndrives

Sleeping: 3-4

Water Capacity: 160L

Cruise Speed: 20-25knots

Top Speed: 38knots



WANT TO KNOW MORE? CONTACT FRASER MARINE NOW:

Phone: 0428 857116

Email: info@frasermarine.com.au

27ft Flybridge Sports Fisherman



The 27 Sports Fisherman features dual-helm stations (Flybridge and Lower), incorporating a spacious galley with a cook top, sink, pantry cupboards and large dinette which converts to bed. A full-flush marine toilet is located within the spacious V-Berth cabin. This combined with her huge open style cockpit area, mighty fuel efficient twin Mercruiser Sterndrives power plants, is a truly versatile and highly sought after vessel.

Each Caribbean vessel delivers over 50 years of experience behind her timeless lines, solid engineering reliability and blue-water offshore performance. All of which has earned Caribbean, the respected reputation as one of the finest boat manufacturers in the world today. Caribbean are proudly built in Scoresby suburb of Melbourne and exported all over the world. Caribbean, the boat the experts buy...

Standard Features

Mechanical and Electrical

- Flybridge and lower helm control stations with dual lever gear and throttle controls, hydraulic steering and comprehensive instrumentation.
- Electric power trim.
- Dual 70 amp/hr batteries with isolating switches.
- Water separating fuel filters.
- Electric bilge blower.
- Automatic electric bilge pump.
- Electric fuel gauge and engine hour meters.
- Navigation and anchor lights.
- 12 volt switch board with protection fuses.
- 12 volt wiring and lighting throughout.
- Pressurised water system.
- 550 litre fuel tank.
- On-board sterndrive oil bottle reservoir.
- 12 volt reversing anchor winch, operational from flybridge, lower helm and deck.
- 12 volt AM/FM stereo/CD player with two speakers.

Floor Plan

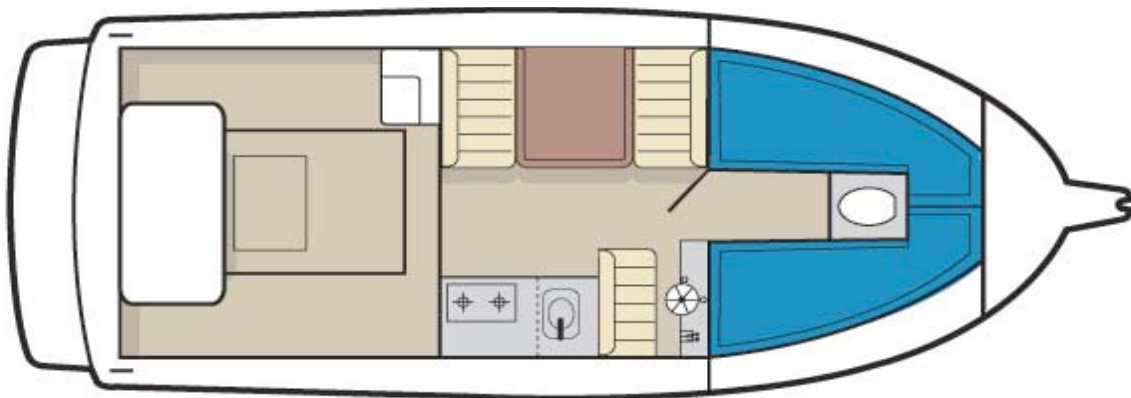

27ft Flybridge Sports Fisherman



Forward Cabin

- Self draining chain locker.
- Dual V-berths with fill in cushions for conversion to double bed and stowage under.
- Upholstered side trays.
- Carpeted throughout.
- Full bulkhead with lock up door.
- Full flush marine toilet.
- Toilet roll holder.
- Mirror
- 12 volt lighting.
- Overhead deck hatch.

Main Cabin

- Armour plate front windows with acrylic sliding side windows.
- Windscreen wipers.
- 12 volt lighting.
- 160 litre water tank.
- Carpeted side stowage pockets.
- Galley unit featuring twin burner spirit stove, stainless steel sink and electric water system.
- Dinette unit with seating for four.
- Helmsman's seat with stowage locker under.
- Comprehensive lower control station.
- Overhead radio panel.

Deck

- Bow platform with electric anchor raising system, anchor and chain.
- Mooring cleats forward and aft.
- Stainless steel bow rail.
- Deck fuel filler.
- Rope lockers X 2.
- Chain locker access.
- Non-skid deck.
- Colour co-ordinated deck & chine lines

Cockpit

- Fibreglass non-skid floor with inspection hatch.
- Fibreglass engine box.
- Engine box cushion.
- Upholstered side panels raised for placement of feet under and easy access to hull sides.
- Deck side stowage compartments.
- Fibreglass swimming platform.
- 12 volt cockpit light.
- Flush mounted cockpit shower in transom panel.
- Fuel tank dipstick.

Flybridge

- Acrylic deflection screen.
- Stainless steel safety rails.
- Stainless steel flybridge ladder with heavy duty steps.
- Vinyl upholstered L shaped fibreglass seat incorporating stowage locker.
- Fibreglass footrest.
- Forward stowage locker with hinged door.
- Flybridge cover.
- 12 volt power socket.
- Full stainless steel targa bimini with envelope.

Towing

For a comprehensive understanding of the current Queensland requirements, please contact Queensland Transport directly on 132380.

For interstate towing, we suggest you contact the Government Office responsible for Motor Vehicle Registrations in the state in which you are heading, for exact confirmation prior to your planned departure.

Warning

Always check your vehicle owner's handbook and your tow-bar compliance, to confirm your manufacturers, recommended tow-capacity and load requirements. Failure to do so, may result in a towing accident or collision resulting in death or serious injury and / or the cancellation of your vehicle's insurance policy together with your boat insurance policy.